

Bearing No. BH-1112

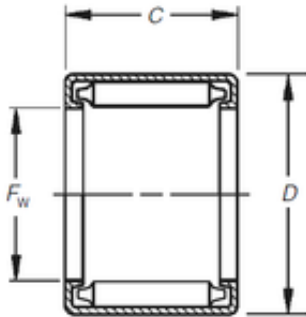

D	23,813 mm
C	19,05 mm
Fw	17,463 mm
Weight	0,023 Kg
Size (mm)	17.463x23.813x19.05
Width (mm)	19,05
Bearing number	BH-1112
Bore Diameter (mm)	17,463
Outer Diameter (mm)	23,813
(Grease) Lubrication Speed	3900 r/min
Basic dynamic load rating (C)	20,9 kN
Basic static load rating (C0)	35,5 kN