

Bearing No. BH-1110

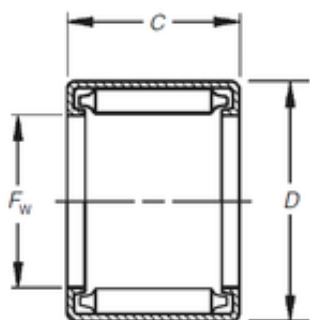

D	23,813 mm
C	15,88 mm
F _w	17,463 mm
Weight	0,019 Kg
Size (mm)	17.463x23.813x15.88
Width (mm)	15,88
Bearing number	BH-1110
Bore Diameter (mm)	17,463
Outer Diameter (mm)	23,813
(Grease) Lubrication Speed	3900 r/min
Basic dynamic load rating (C)	17,3 kN
Basic static load rating (C ₀)	27,8 kN