

Bearing No. BH-1016

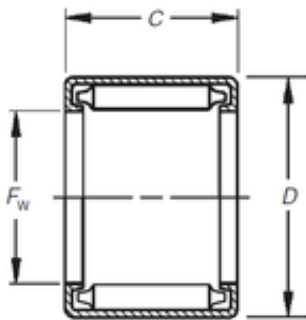

D	22,212 mm
C	25,4 mm
Fw	15,875 mm
Weight	0,028 Kg
Size (mm)	15.875x22.212x25.4
Width (mm)	25,4
Bearing number	BH-1016
Bore Diameter (mm)	15,875
Outer Diameter (mm)	22,212
(Grease) Lubrication Speed	4200 r/min
Basic dynamic load rating (C)	26,2 kN
Basic static load rating (C0)	46,3 kN