

Bearing No. BH-1012

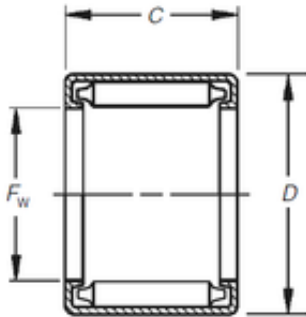

D	22,212 mm
C	19,05 mm
Fw	15,875 mm
Weight	0,021 Kg
Size (mm)	15.875x22.212x19.05
Width (mm)	19,05
Bearing number	BH-1012
Bore Diameter (mm)	15,875
Outer Diameter (mm)	22,212
(Grease) Lubrication Speed	4200 r/min
Basic dynamic load rating (C)	19,8 kN
Basic static load rating (C0)	32,3 kN