

Bearing No. B-96

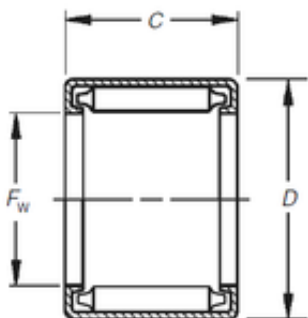

D	19,05 mm
C	9,53 mm
Fw	14,288 mm
Weight	0,007 Kg
Size (mm)	14.288x19.05x9.53
Width (mm)	9,53
Bearing number	B-96
Bore Diameter (mm)	14,288
Outer Diameter (mm)	19,05
(Grease) Lubrication Speed	3300 r/min
Basic dynamic load rating (C)	7,34 kN
Basic static load rating (C0)	11,4 kN