

Bearing No. B-912

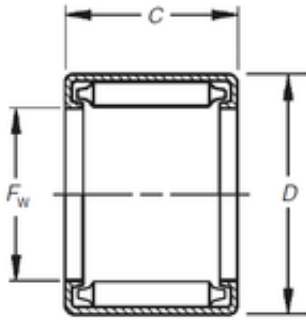

D	19,05 mm
C	19,05 mm
Fw	14,288 mm
Weight	0,014 Kg
Size (mm)	14.288x19.05x19.05
Width (mm)	19,05
Bearing number	B-912
Bore Diameter (mm)	14,288
Outer Diameter (mm)	19,05
(Grease) Lubrication Speed	3300 r/min
Basic dynamic load rating (C)	15,7 kN
Basic static load rating (C0)	30,3 kN