

Bearing No. B-68

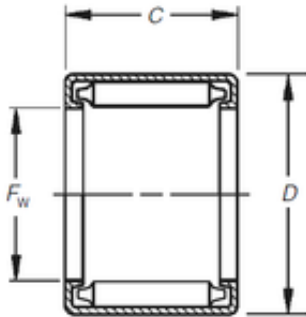

D	14,288 mm
C	12,7 mm
Fw	9,525 mm
Weight	0,007 Kg
Size (mm)	9.525x14.288x12.7
Width (mm)	12,7
Bearing number	B-68
Bore Diameter (mm)	9,525
Outer Diameter (mm)	14,288
(Grease) Lubrication Speed	4600 r/min
Basic dynamic load rating (C)	8,18 kN
Basic static load rating (C0)	11,8 kN