

### Bearing No. B-610

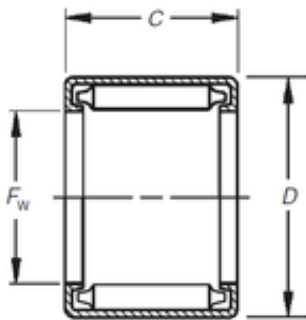

D	14,288 mm
C	15,88 mm
Fw	9,525 mm
Weight	0,008 Kg
Size (mm)	9.525x14.288x15.88
Width (mm)	15,88
Bearing number	B-610
Bore Diameter (mm)	9,525
Outer Diameter (mm)	14,288
(Grease) Lubrication Speed	4600 r/min
Basic dynamic load rating (C)	10,4 kN
Basic static load rating (C0)	16 kN