

### Bearing No. B-45

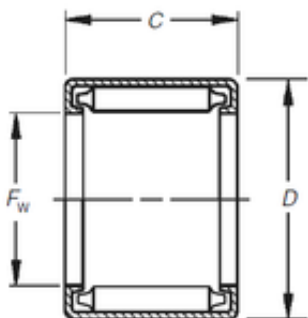

D	11,113 mm
C	7,92 mm
Fw	6,35 mm
Weight	0,003 Kg
Size (mm)	6.35x11.113x7.92
Width (mm)	7,92
Bearing number	B-45
Bore Diameter (mm)	6,35
Outer Diameter (mm)	11,113
(Grease) Lubrication Speed	6500 r/min
Basic dynamic load rating (C)	3,56 kN
Basic static load rating (C0)	3,69 kN