

Bearing No. B-36

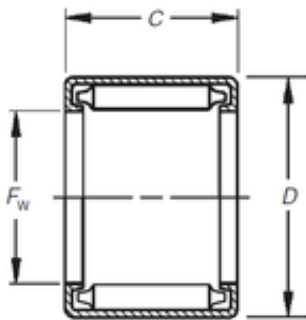

D	8,733 mm
C	9,53 mm
Fw	4,763 mm
Weight	0,002 Kg
Size (mm)	4.763x8.733x9.53
Width (mm)	9,53
Bearing number	B-36
Bore Diameter (mm)	4,763
Outer Diameter (mm)	8,733
(Grease) Lubrication Speed	7000 r/min
Basic dynamic load rating (C)	3,78 kN
Basic static load rating (C0)	4,23 kN