

Bearing No. B-128

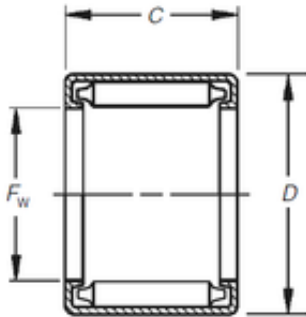

D	25,4 mm
C	12,7 mm
Fw	19,05 mm
Weight	0,016 Kg
Size (mm)	19.05x25.4x12.7
Width (mm)	12,7
Bearing number	B-128
Bore Diameter (mm)	19,05
Outer Diameter (mm)	25,4
(Grease) Lubrication Speed	3600 r/min
Basic dynamic load rating (C)	14,1 kN
Basic static load rating (C0)	22 kN